

CAT:	FEET:
TYPE:	PROJECT:
	

Discreet compact (1¼" x 1¼"), hidden light source tamper-resistant linear LED lighting system.

Features

- Optically clear polycarbonate co-extruded directional lens features 60° lighting cut-off for hidden, discreet illumination.
- Base and lens available in 8' field cuttable lengths with optional row indicator window.
- Use with Tivoli's patented two-tone bullnose stair nosing with reflective edge.

Mounting

- Designed for aisle walls and staircases.
- Suggested mounting height above floor is minimum 15" for standard 4' pathway, minimum 12" for pathway less than 4'.
- 35° Up, 35° Down, inside corner, outside corner, and straight run joiner brackets available for ease of installation.

Applications

Ideal for wall mounted step and aisle lighting applications.

Warranty

5 years

Technical Information



*Lumens/ft	33
*Watts/ft	1.45
CRI	93
Kelvin Temp	2700K, 3000K, 4000K, 6200K (+/-100K), Amber, Red, Blue
Rated Life	75,000 hrs.
Max Run Length (Electrical)	32'
Order Increments	8' Sections
Operating Voltage	12V DC
Power Supply	Class 2
Dimmable	Yes

*Based on 3000K Sample

Profile Dimensions

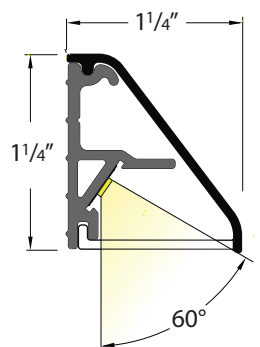

Ordering Information

PRODUCT CODE		COLOR		FINISH		FIXTURE LENGTH
FWC	-		-	M	-	8.0
FWC= Fantasma Wall Continuous						
		27 = 2700K 30 = 3000K 40 = 4000K 62 = 6200K AM = Amber RD = Red BL = Blue				8.0 = 8'
		M = Matte				

Recommended Power Supplies

ADUL - NON DIMMING

DESCRIPTION	CAT NO	APPLICATION	PRIMARY VOLTAGE	SECONDARY VOLTAGE	CIRCUIT BREAKERS	MAX LOAD	CIRCUIT CAPACITY
ADUL Series Class 2 Transformer	ADUL-80-1-5-12-D	Indoor / Damp	100-277V AC 50/60 HZ	12V DC	1	60W	5A
	ADUL-150-2-5-12-D				2	2x60W	2x5A
	ADUL-240-3-5-12-D				3	3x60W	3x5A
	ADUL-320-4-5-12-D				4	4x60W	4x5A

ADUL - 0-10V DIMMING

DESCRIPTION	CAT NO	APPLICATION	PRIMARY VOLTAGE	SECONDARY VOLTAGE	CIRCUIT BREAKERS	MAX LOAD	CIRCUIT CAPACITY
ADUL Series Class 2 Transformer	ADUL-80-1-5-12-DOT	Indoor / Damp	100-277V AC 50/60 HZ	12V DC	1	60W	5A
	ADUL-150-2-5-12-DOT				2	2x60W	2x5A
	ADUL-240-3-5-12-DOT				3	3x60W	3x5A
	ADUL-320-4-5-12-DOT				4	4x60W	4x5A

ADUL - DMX SINGLE ADDRESS

DESCRIPTION	CAT NO	APPLICATION	PRIMARY VOLTAGE	SECONDARY VOLTAGE	CIRCUIT BREAKERS	MAX LOAD	CIRCUIT CAPACITY
ADUL Series Class 2 Transformer	ADUL-80-1-5-12-DIN	Indoor / Damp	100-277V AC 50/60 HZ	12V DC	1	60W	5A
	ADUL-150-2-5-12-DIN				2	2x60W	2x5A
	ADUL-240-3-5-12-DIN				3	3x60W	3x5A

ADUL - DMX MULTI ADDRESS

DESCRIPTION	CAT NO	APPLICATION	PRIMARY VOLTAGE	SECONDARY VOLTAGE	CIRCUIT BREAKERS	MAX LOAD	CIRCUIT CAPACITY
ADUL Series Class 2 Transformer	ADUL-150-2-5-12-DIN-2	Indoor / Damp	100-277V AC 50/60 HZ	12V DC	2	2x60W	2x5A
	ADUL-240-3-5-12-DIN-3				3	3x60W	3x5A
	ADUL-320-4-5-12-DIN-4				4	4x60W	4x5A

INFINITY - MLV / ELV / 0-10V / PWM / TRIAC

DESCRIPTION	CAT NO	APPLICATION	PRIMARY VOLTAGE	SECONDARY VOLTAGE	CIRCUIT BREAKERS	MAX LOAD	MIN LOAD	CIRCUIT CAPACITY
Infinity Series Class 2 Transformer	INF-J-30-1-2.5-12	Indoor / Outdoor	100 - 277V AC	12V DC	1	30W	3W	2.5A
	INF-J-60-1-5-12				1	60W	6W	5A
	INF-J-180-3-5-12				3	3x60W	3x6W	3x5A
	INF-J-300-5-5-12				5	5x60W	5x6W	5x5A

Recommended Dimmers

DIMMING - 0-10V

DESCRIPTION	CAT NO	APPLICATION	INPUT VOLTAGE	OUTPUT VOLTAGE	MAX LOAD
0-10V Dimmer	DIM-LD-010	Indoor	12V/24V DC	12V/24V DC	30 mA max. output (sink only)

DIMMING - MLV

DESCRIPTION	CAT NO	APPLICATION	INPUT VOLTAGE	OUTPUT VOLTAGE	MAX LOAD
MLV Dimmer	N-600	Indoor	120V AC	120V AC	450W
	N-1000				800W
	N-1500				1200W
	D-600				450W
	M-600				450W
	M-1000				800W

DIMMING - ELV

DESCRIPTION	CAT NO	APPLICATION	INPUT VOLTAGE	OUTPUT VOLTAGE	MAX LOAD
ELV Dimmer	ME-600	Indoor	120V AC	120V AC	450W
	DE-300				300W

DIMMING - DMX

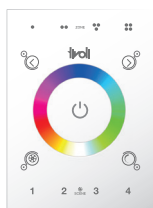

TVOQ-1-WH
White

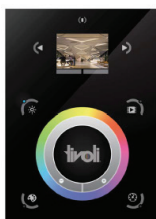

TVOQ-10-XX-7
XX = BK (Black), WH (White)

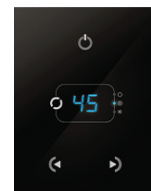

TVOQ-2-BK
Black

Mounting Accessories & Replacement Parts

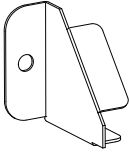

FANTASMA END CAP
FWTT-EC-L
 Left End Cap (shown)
FWTT-EC-R
 Right End Cap

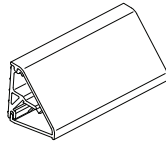

FWC-LENS-M-8
 Fantasma lens - 8'
WLS-BASE-8
 Wall light system base - 8'

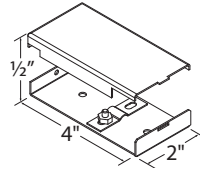

JBOX-LP
 Junction box, low profile



BSL-PC-1/4
 1/4" Flex Conduit, Black

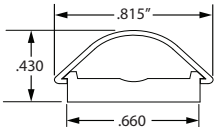

BS-CC-8
 Wall wireway, 8' Black Base
 & Conduit Cover

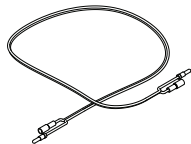

FWC-JUMPER-2
 24 inch lead jumper



TM-2-3/8
 Self tapping wall screw,
 Phillips profile - 2 3/8" length

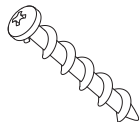

TM-1-1/2
 Self tapping, deep cutting,
 corkscrew-like thread,
 Phillips profile - 1 1/2" length

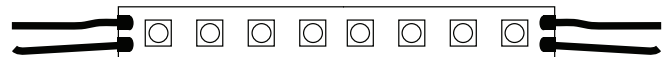

Replacement light engine, Sold per ft. and includes leads on both ends with 18-22AWG butt connectors attached. Specify length at time of ordering.

FWCLE-LB-I-27-12
 Low Brightness TivoTape, 2700K, 12V
FWCLE-LB-I-30-12
 Low Brightness TivoTape, 3000K, 12V
FWCLE-LB-I-40-12
 Low Brightness TivoTape, 4000K, 12V
FWCLE-LB-I-62-12
 Low Brightness TivoTape, 6200K, 12V

FWCLE-LB-I-AM-12
 Low Brightness TivoTape, AMBER, 12V
FWCLE-LB-I-RD-12
 Low Brightness TivoTape, RED, 12V
FWCLE-LB-I-BL-12
 Low Brightness TivoTape, BLUE, 12V

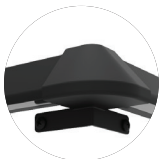

FWTT-O-CRNR
 Outside corner joint,
 matte black



FWTT-I-CRNR
 Inside corner
 joint, matte black

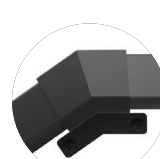

FWTT-D-JNT
 35° Down wall joint



FWTT-U-JNT
 35° Up wall joint



FWTT-ST-JNT
 Straight Joint



FWTT-OV-CRNR
 90° Outside
 vertical Joint,
 matte black



FWTT-IV-CRNR
 90° Inside
 vertical Joint,
 matte black

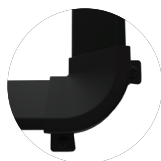

90° Vertical
Outside



90° Vertical
Inside

90° Vertical Inside and Outside Joints

Engineered for new theater formats that include reclining seats; these new brackets enable full cut off glare. The vertical part of the assembly over the stairs acts as a wire way to continuous LEDs installed on the horizontal portion over each step to achieve the full cut off of glare. This new method follows the stair line versus the hand rail line of the 35° joint.

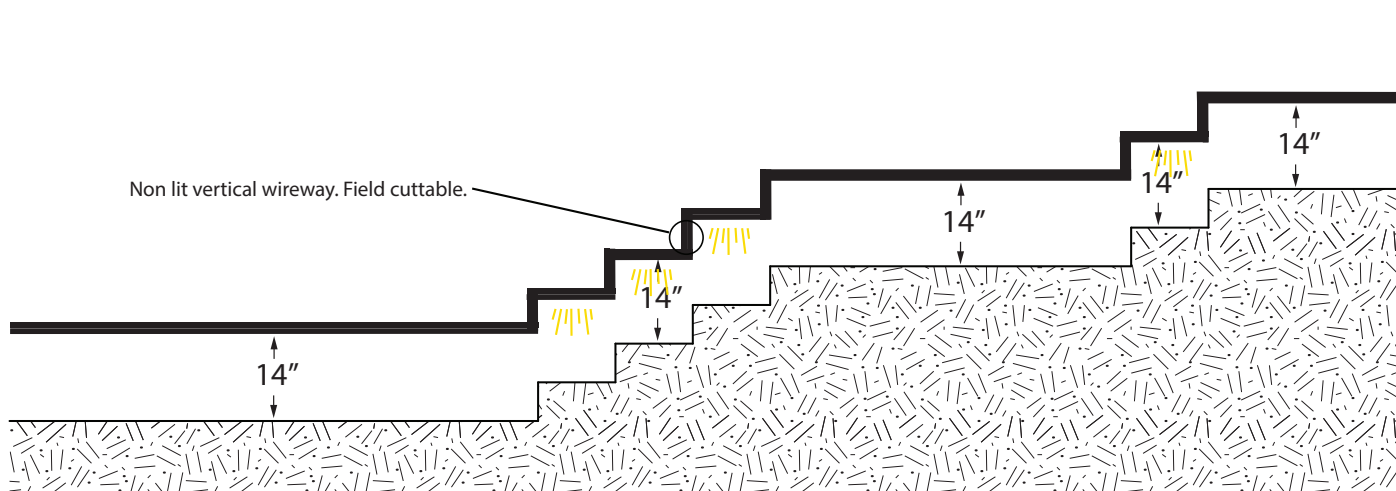

35° Up



35° Down

35° Joints

Engineered for 35° downward mounting angles over the stairs, in theaters, where standard seating and landing spacing are utilized. This method may not fully eliminate glare as with the 90° joints and installation method.

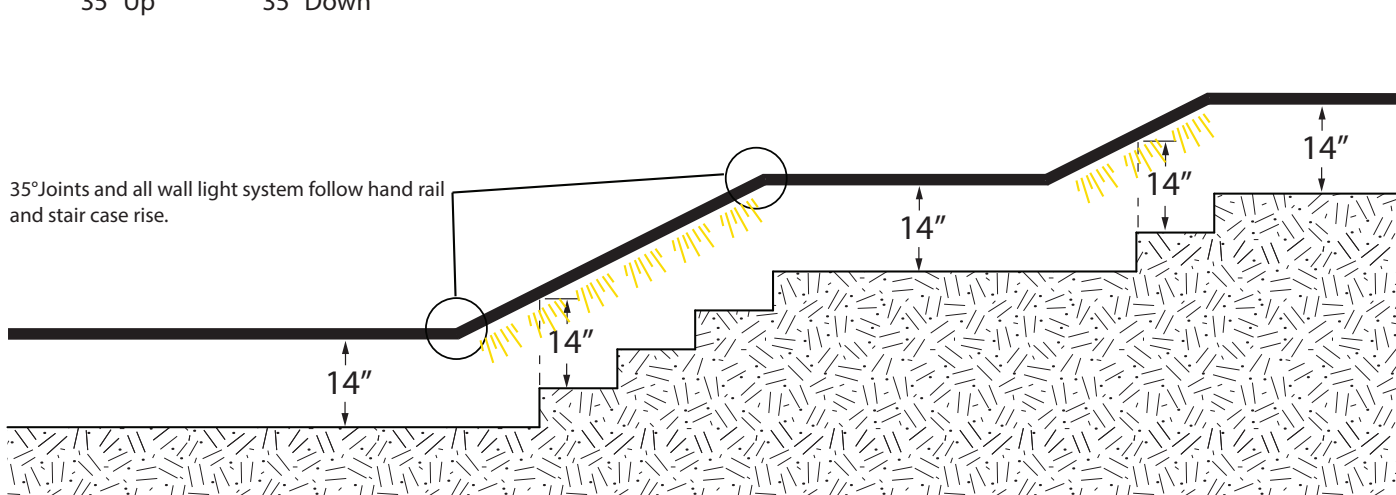

TwoTone Bullnose & Accessories

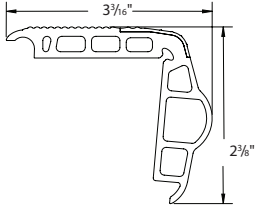

Bullnose Extrusion

BNS-TT-GY-12

TwoTone Bullnose, 12' length, Black/Gray Strip

BNS-TT2-GY-12

TwoTone Bullnose, 12' length, Black/2" Gray Strip

BNS-SC-GY-12

Bullnose, Solid Gray, 12' Length

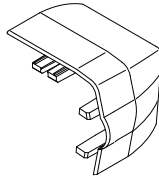

Bullnose End Caps

BNS-TT-EC-L

End Cap, Left Side Overlap Design, Black

BNS-TT-EC-R

End Cap, Right Side Overlap Design, Black

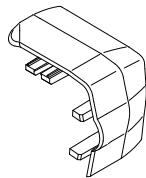

CC Bullnose End Caps (Carpet-To-Carpet)

BNS-CC-TT-EC-L

End Cap, Carpet-To-Carpet, Left Side, Black

BNS-CC-TT-EC-R

End Cap, Carpet-To-Carpet, Right, Black

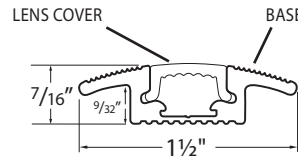

CC & CW Wire Way Combo - Base & Lens

WW-CC-BK-8

Carpet to Carpet Base and Cover 8' - Black

WW-CC-GY-8

Carpet to Carpet Base and Cover 8' - Gray

WW-CW-BK-8

Carpet to Wall Base and Cover 8' - Black

WW-CW-GY-8

Carpet to Wall Base and Cover 8' - Gray

CC & CW Wire Way Base ONLY

WW-CW-BS-8

Base Only, Carpet to Wall, Black, 8'

WW-CC-BS-8

Base Only, Carpet to Carpet, Black, 8'

CC & CW Wire Way Lens ONLY

WW-TC-CL-8

Lens Cover Only, Clear, 8'

WW-TC-BK-8

Lens Cover Only, Black, 8'

WW-TC-BZ-8

Lens Cover Only, Bronze, 8'

WW-TC-GY-8

Lens Cover Only, Gray, 8'

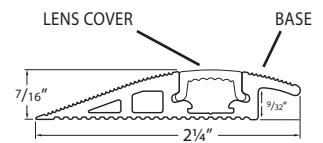

CE Wire Way Combo - Base & Lens

WW-CE-BK-8

Carpet to Edge Base and Cover 8' - Black

WW-CE-GY-8

Carpet to Edge Base and Cover 8' - Gray

CE Wire Way Base ONLY

WW-CE-BS-8

Base Only, Carpet To Edge, Black, 8'

CE Wire Way Lens ONLY

WW-TC-CL-8

Lens Cover Only, Clear, 8'

WW-TC-BK-8

Lens Cover Only, Black, 8'

WW-TC-BZ-8

Lens Cover Only, Bronze, 8'

WW-TC-GY-8

Lens Cover Only, Gray, 8'

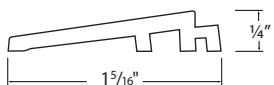

BNS-TT-R-12

Step Reducer, 12' Section

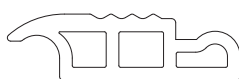

STP-EXTNDR-12

Bullnose Step Landing Tread Extender, 12'



ADH-MB-75AM-10

Extrusion adhesive, 10.1 oz tubes, sold individually. 30 per case.

ADH-MB-75AM-29

Extrusion adhesive, 29 oz tubes, sold individually. 12 per case.



ADH-IA-10.2-CA

End Cap Adhesive, Clear liquid adhesive for end caps. 10.2 oz tubes sold individually. 12 per case.

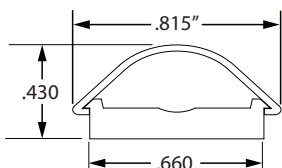

BS-CC-8

Wall wireway, 8' Black Base & Conduit Cover

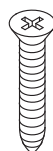

TM-3/16

Concrete Screw 3/16" x 1 3/4"

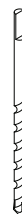

RONDB-5/32

Concrete Drill Bit 5/32"